

ELITE model

Minibar equipped with an ultra-quiet, next generation inverter compressor for hotels seeking maximum performance and comfort with minimum power consumption.



VANGUARD

Technology, performance, efficiency, comfort and savings are the features of the minibar that set the trend

EFFICIENCY

A++



RTC TIMER

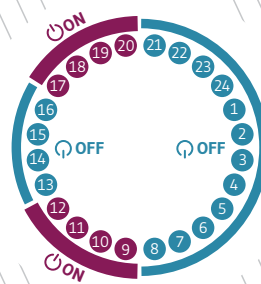

24H COLD
LESS CONSUMPTION



PERFORMANCE



ELEGANCE



SAVINGS



Maximum performance with **minimum consumption**

ELITE represents the top of the range of mini-bars with a quiet inverter compressor. High performance, minimum consumption and acoustic insulation that makes the noise level imperceptible at a distance of 1 meter or more from the minibar.

The RTC (Real Time Clock) option allows programming of the minibar to automatically turn off during resting hours optimizing consumption.

OMNITEC, international partner for quality and performance

Energy Savings Estimate* elite 45 absorption

Consumption (Kwh/24 h)	0,116	0,75
Cost in Euro/Year (0.15 €/Kwh)	6,35 €	41,07 €
Annual Saving per Minibar €	34,72 €	

general characteristics

- **Technology:** Ultra silent inverter compressor
- **Voltage:** 220-240 V (110 V optional)
- **Power:** 53 to 58 W

standard features

- No Frost
- Low consumption interior LED
- Additional hinge for left opening. Easy and fast change
- Adjustable trays and bottle holders
- Bottle holder for 1 L bottle

available dimensions

volume	dimensions height x width x depth	consumption	efficiency
35 litres	510 x 382 x 456 mm	0,133 Kw/24 h	A++
45 litres	566 x 427 x 472 mm	0,116 Kw/24 h	A++
60 litres	640 x 550 x 560 mm	0,26 Kw/24 h	A++

specific project options



Lock on the minibar door



Casters



RTC - Real Time Clock



Sliding guide



Glass door Personalization optional



Aluminum Trays



Minibars

cool sensations for your guests

International Experience



recommendations for installation

Our minibars will reach their **maximum performance, minimum consumption** and longest life span working under appropriate conditions of heat diffusion.

Following the directions shown below will allow the minibar to operate at its optimal performance level and therefore yield the highest return on investment.

environmental conditions

The ambient room temperature is crucial for the proper functioning of the minibar. A high ambient temperature reduces the airflow around the minibar and its ability to dissipate heat, this will influence the performance of the minibar considerably due to a lack of ventilation.

In **OMNITEC** we offer you our extensive experience to assist you in planning your installation and get the most out of our mini-bars. Following our indications your guests will enjoy maximum comfort.

ventilation system

The basic concept is to allow air to circulate around the minibar to evacuate the heat generated by the cooling system.

On all **OMNITEC** Minibars, the cooling system is located at the rear of the unit. For optimal performance there should be an intake at the front base of the minibar, and an outlet at the top of the backside to allow cool air to flow under the minibar, along the back, evacuating hot air at the top.

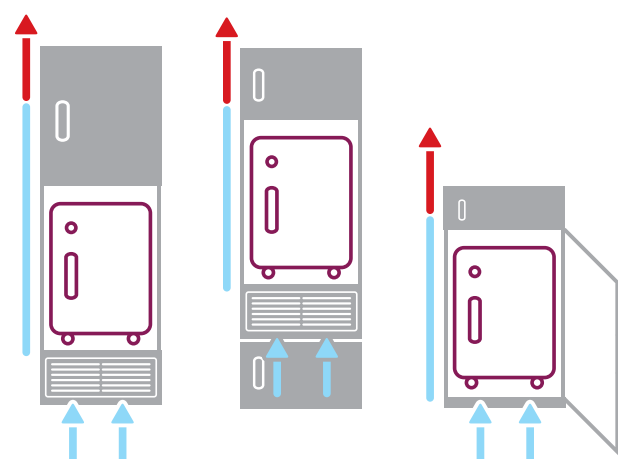

REFERENCES



- | | |
|-----------------------------------|-------------------------------------|
| Iberostar Santa Eulalia 4* Spain | Hilton Tanger 4* Morocco |
| Barceló Torre de Madrid 4* Spain | The Grange Hotel 5* United Kingdom |
| Radisson Blu Podil 4* Ukraine | Hôtel Faidherbe 3* France |
| Fergus Style Palmanova 4* Spain | Dream Hotel 4* Belgium |
| Crown Paradise Vallarta 5* Mexico | Hotel Dina Morgabine 3* Reunion |
| Hard Rock Kantenah 5* Mexico | Hotel Africa Jade 4* Tunisia |
| Finest Isla Mujeres 5* Spain | Heston Hide Hotel 4* United Kingdom |
| Hard Rock Hotel Ibiza 5* Spain | Santa Catalina 5* Spain |

look for more references in our website