

## C model

Minibar with a silent compressor, tailored to the needs of hotels looking for a powerful and rapid cooling system with low power consumption.



### PERFORMANCE

High cooling capacity in demanding environments



### High performance in any environment

The Model C minibars function with a perfectly calibrated compressor system to maintain the optimum cooling temperature for drinks and snacks in the minibar.

OMNITEC, international partner for quality and performance

### general characteristics

- **Technology:** silent compressor
- **Voltage:** 220-240 V (110 V optional)
- **Power:** 85 W
- **Energy Efficiency:** up to A++

### standard features

- No Frost
- Adjustable thermostat
- Low consumption interior LED
- Additional hinge for left opening. Easy and fast change
- Adjustable trays

### available dimensions

volume	dimensions height x width x depth	consumption	efficiency
35 litres	552 x 403 x 438 mm	0,35 Kw/24h	A
50 litres	525 x 440 x 500 mm	0,40 Kw/24h	A+
65 litres	650 x 474 x 445 mm	0,29 Kw/24h	A++
85 litres	840 x 474 x 435 mm	0,37 Kw/24h	A

### specific project options



Lock on the minibar door



Casters



Sliding guide



Glass door  
Personalization optional



## Minibars

cool sensations for your guests

International Experience



### recommendations for installation

Our minibars will reach their **maximum performance, minimum consumption** and longest life span working under appropriate conditions of heat diffusion.

Following the directions shown below will allow the minibar to operate at its optimal performance level and therefore yield the highest return on investment.

### environmental conditions

The ambient room temperature is crucial for the proper functioning of the minibar. A high ambient temperature reduces the airflow around the minibar and its ability to dissipate heat, this will influence the performance of the minibar considerably due to a lack of ventilation.

In **OMNITEC** we offer you our extensive experience to assist you in planning your installation and get the most out of our mini-bars. Following our indications your guests will enjoy maximum comfort.

### ventilation system

The basic concept is to allow air to circulate around the minibar to evacuate the heat generated by the cooling system.

On all **OMNITEC** Minibars, the cooling system is located at the rear of the unit. For optimal performance there should be an intake at the front base of the minibar, and an outlet at the top of the backside to allow cool air to flow under the minibar, along the back, evacuating hot air at the top.

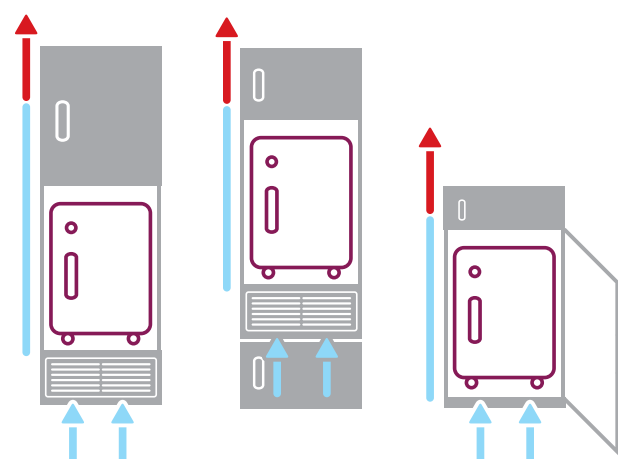

### REFERENCES



- |                                   |                                     |
|-----------------------------------|-------------------------------------|
| Iberostar Santa Eulalia 4* Spain  | Hilton Tanger 4* Morocco            |
| Barceló Torre de Madrid 4* Spain  | The Grange Hotel 5* United Kingdom  |
| Radisson Blu Podil 4* Ukraine     | Hôtel Faidherbe 3* France           |
| Fergus Style Palmanova 4* Spain   | Dream Hotel 4* Belgium              |
| Crown Paradise Vallarta 5* Mexico | Hotel Dina Morgabine 3* Reunion     |
| Hard Rock Kantenah 5* Mexico      | Hotel Africa Jade 4* Tunisia        |
| Finest Isla Mujeres 5* Spain      | Heston Hide Hotel 4* United Kingdom |
| Hard Rock Hotel Ibiza 5* Spain    | Santa Catalina 5* Spain             |

look for more references in our website